



WILLE

JUSTOWSKIE

DOM G

pow. domu: 341,11 m²
pow. garażu: 32,26 m²
suma: **373,37 m²**

Poziom -1: 86,75 m²

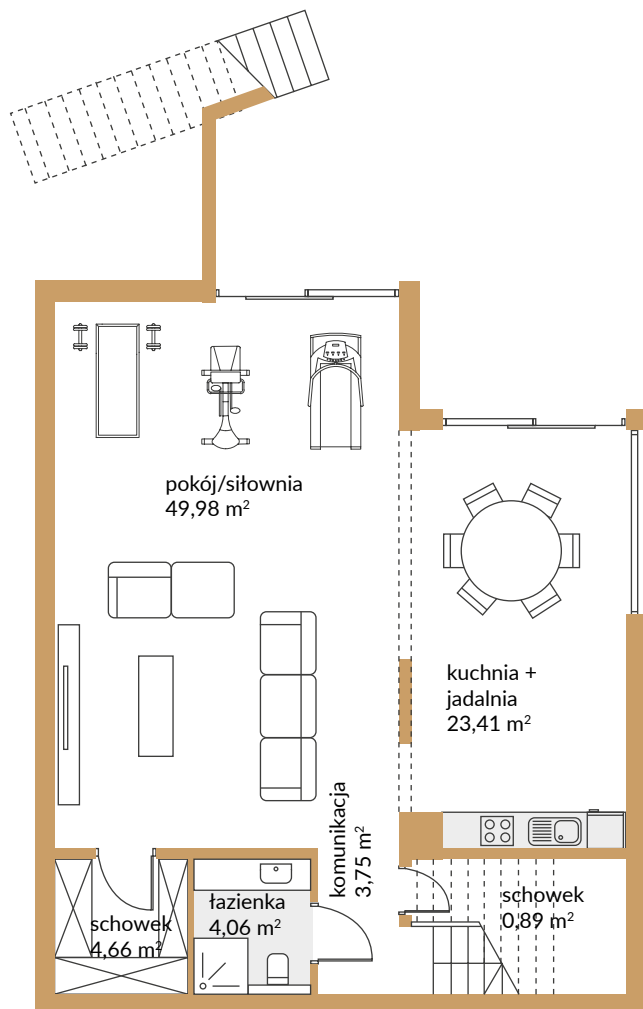

Parter: 124,85 m²

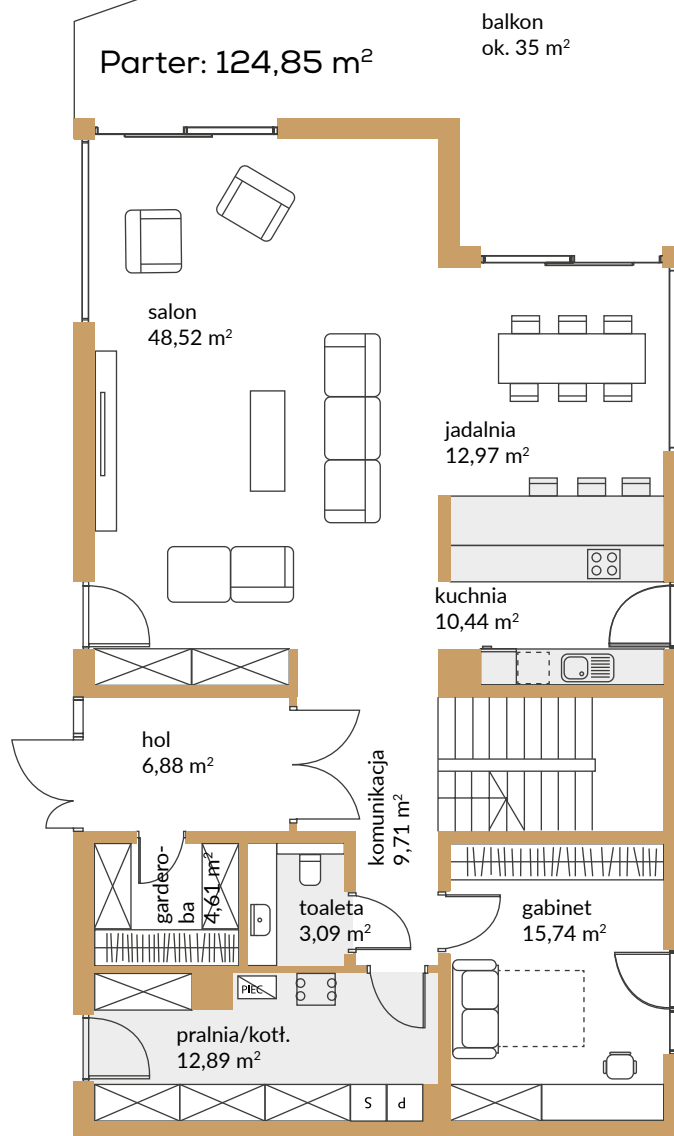

1 piętro: 129,51 m²

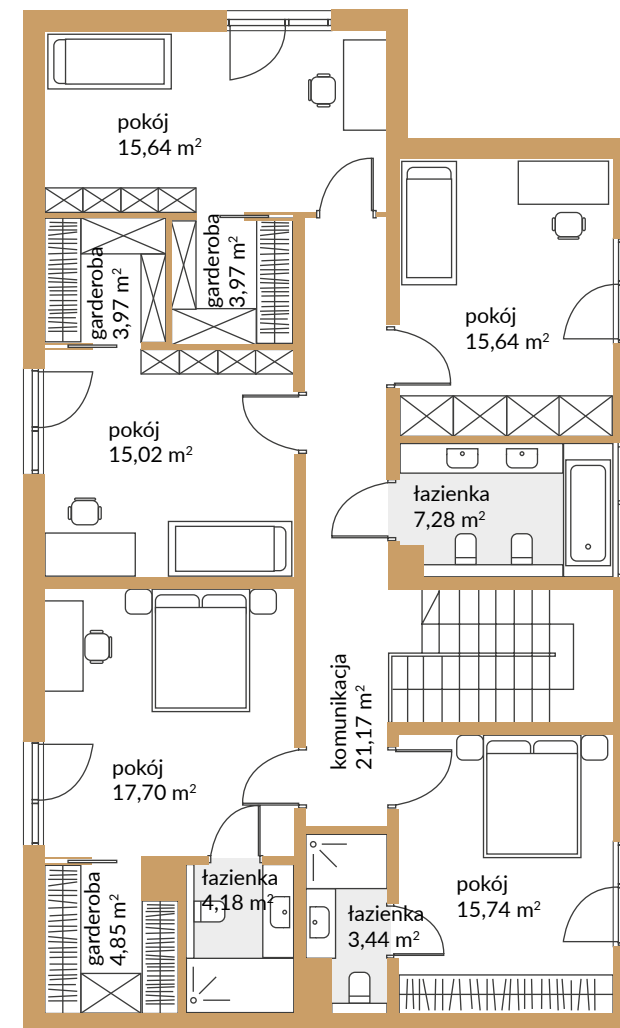



WILLE

JUSTOWSKIE

DOM G

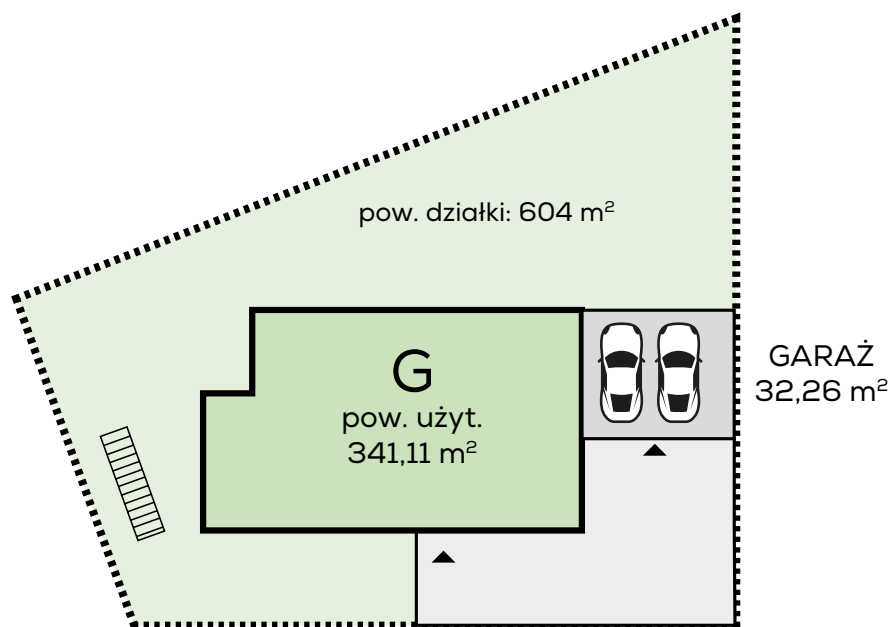

ZAGOSPODAROWANIE TERENU

