



WILLE

JUSTOWSKIE

DOM B | Lokal 2

pow. domu: 123,08 m²
pow. garażu: 15,82 m²
suma: **138,90 m²**

Parter: 59,71 m²

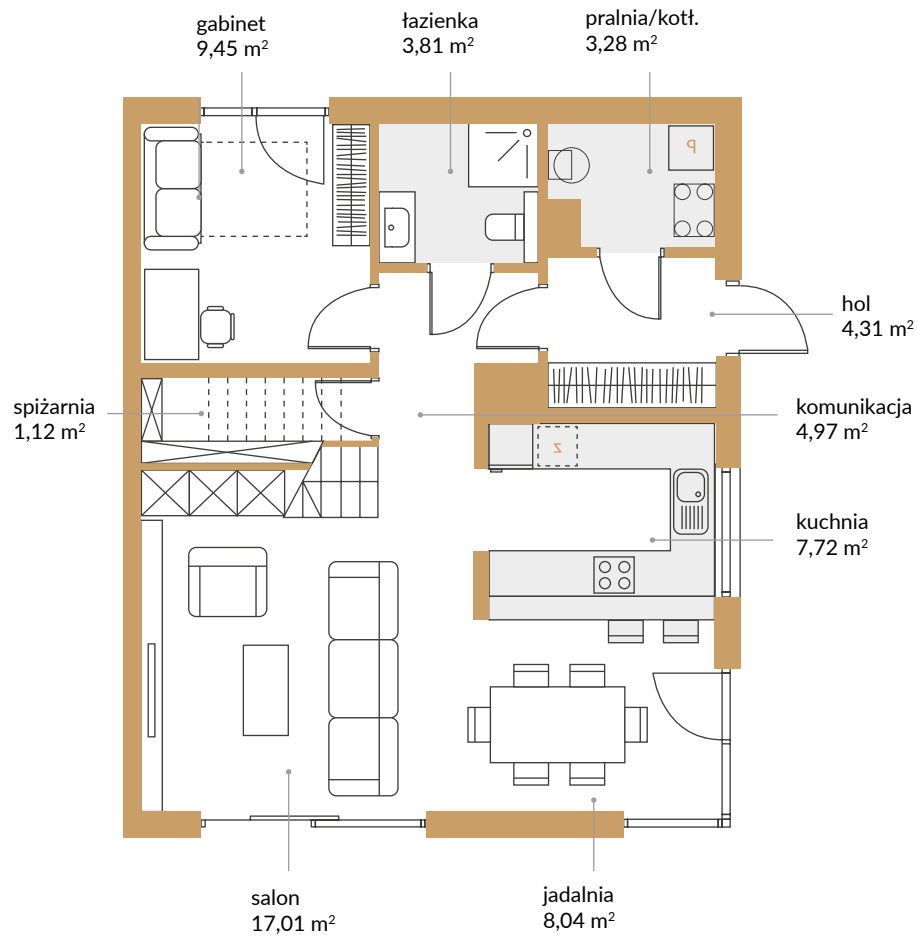

1 piętro: 63,37 m²

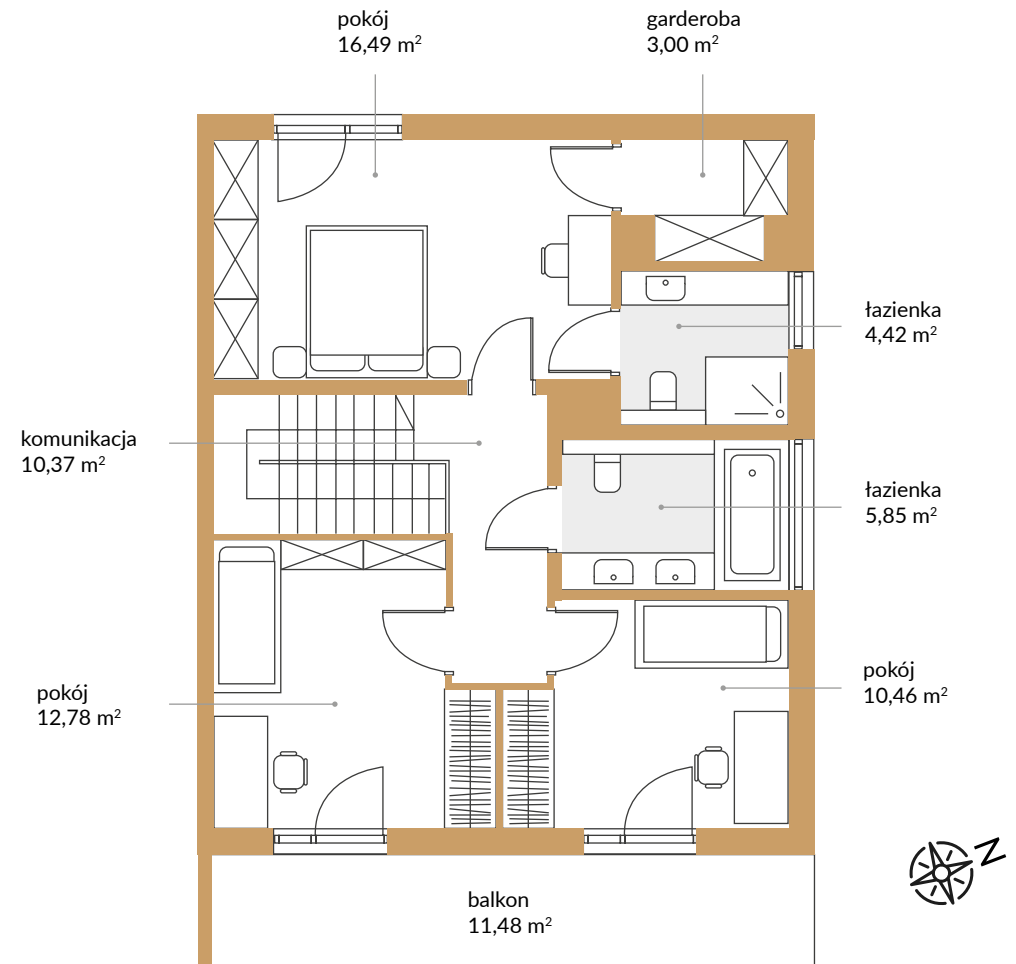



WILLE

JUSTOWSKIE

DOM B | Lokal 2

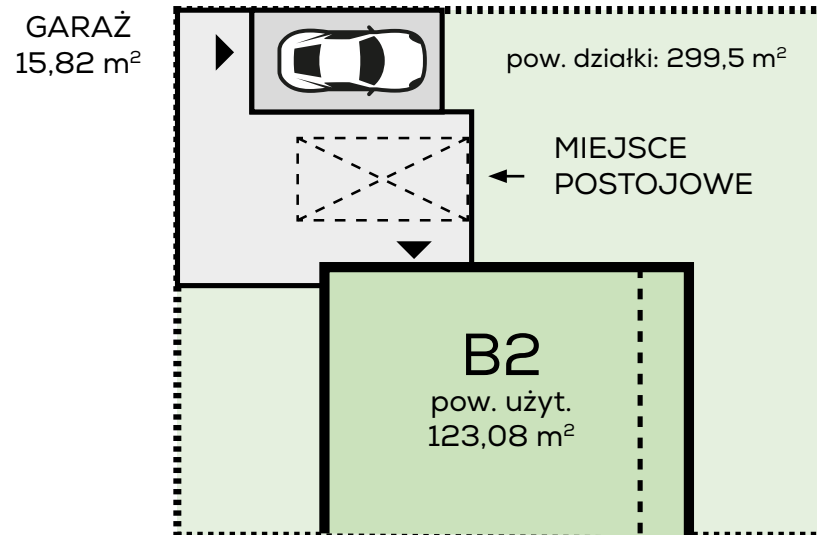

ZAGOSPODAROWANIE TERENU

