



# WILLE

JUSTOWSKIE

## DOM B | Lokal 1

pow. domu: 123,08 m<sup>2</sup>  
pow. garażu: 15,82 m<sup>2</sup>  
suma: **138,90 m<sup>2</sup>**

Parter: 59,71 m<sup>2</sup>

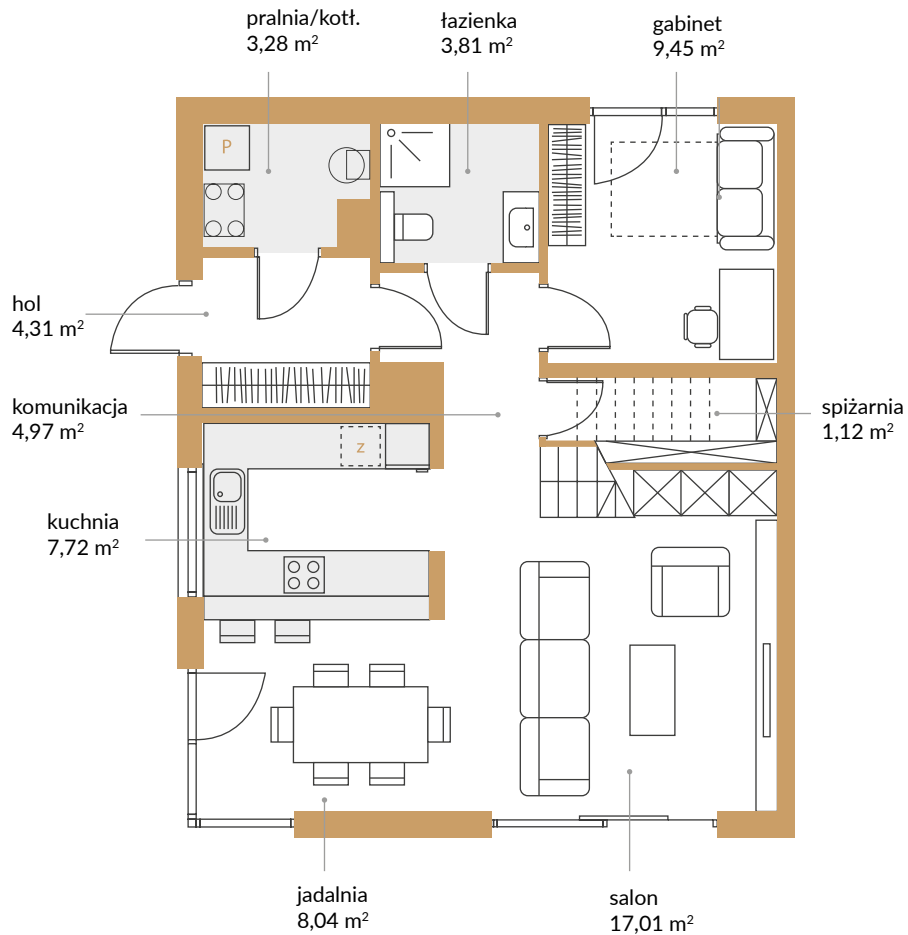

1 piętro: 63,37 m<sup>2</sup>

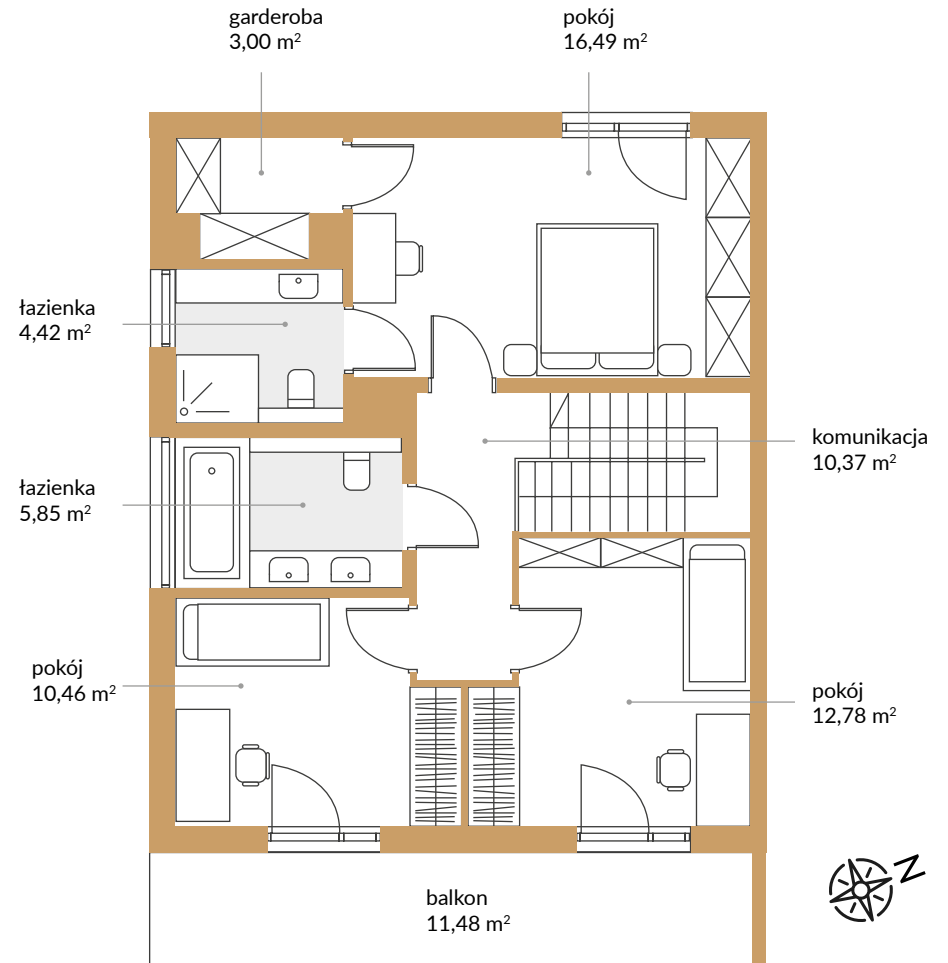



# WILLE

JUSTOWSKIE

## DOM B | Lokal 1

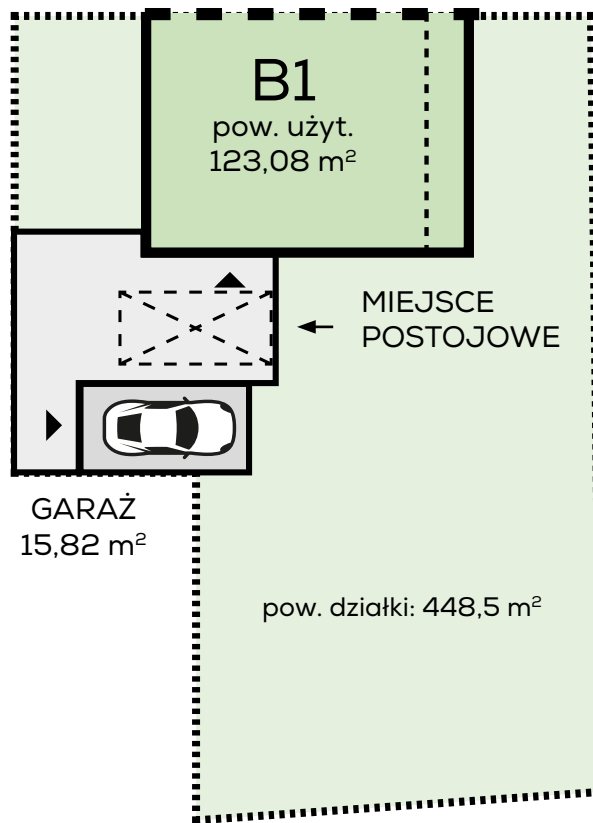

### ZAGOSPODAROWANIE TERENU

